

Ringe - Faaborg.

1882

Tyenske Verhør

RINGE - FAABORG.

1882.

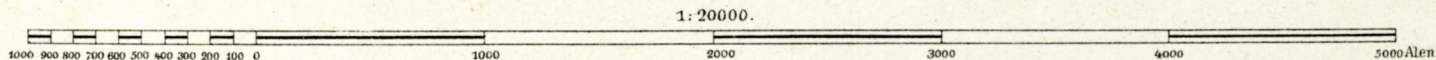

Forklaring.

| | | | | | |
|---|--|------------------------------------|--|---|--|
| <i>Byskjel</i> | | <i>Steenkiste</i> | | <i>Exproprieret og for bestandig afstaaet Grund udenfor selve Banen</i> | |
| <i>Sogneskjel</i> | | <i>Rörledning</i> | | <i>Exproprieret Grund, der senere er solgt eller agtes solgt</i> | |
| <i>Herredsskjel</i> | | <i>Offentlig Niveauoverkjørsel</i> | | <i>Stations Hovedbygning</i> | |
| <i>Amtsskjel</i> | | <i>Privat do</i> | | <i>Banevogterhus</i> | |
| <i>Banens Stations N^o og Mileinddeling</i> | | <i>Niveauovergang</i> | | | |
| <i>Viaduct over Banen</i> | | <i>Aflagt Vei</i> | | | |
| <i>do under do</i> | | <i>Veianlæg</i> | | | |
| <i>Bro</i> | | <i>Aasforlægning</i> | | | |



Ryslinge Sogn

Lørup

Södinge

Longbjerg

Ringe

Ringe Station

Rynkeby

Brangstrup

N.

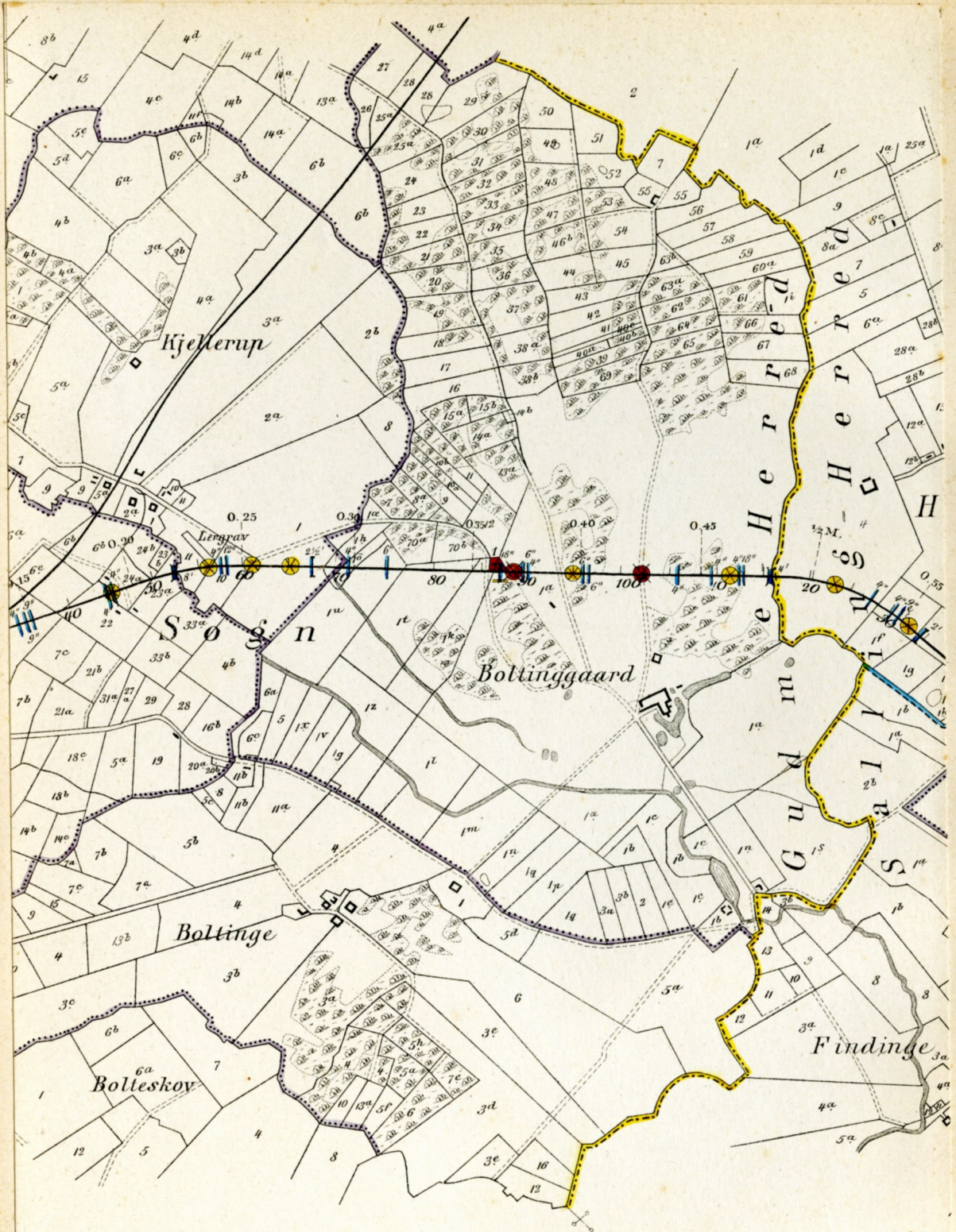

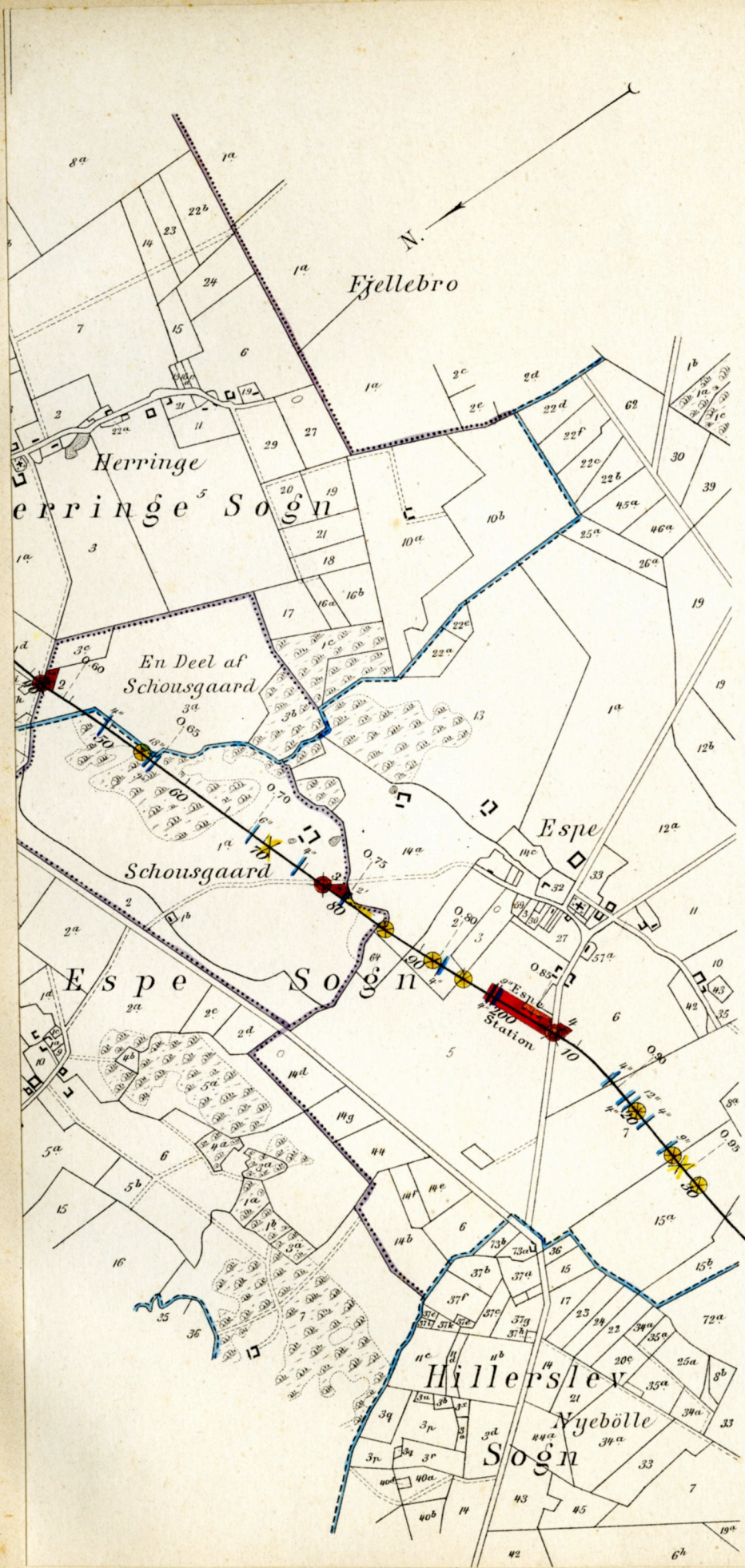

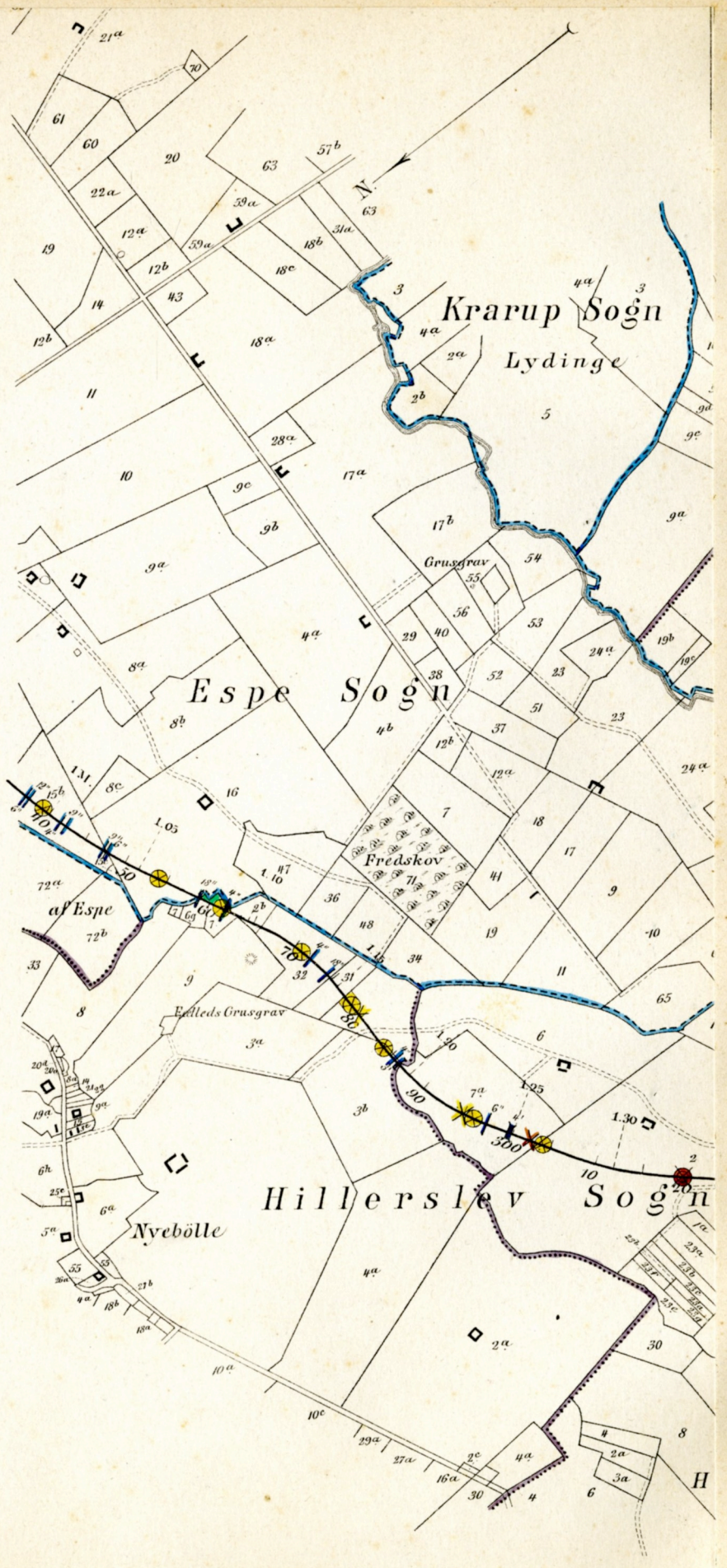

Krarup Sogn
Lydinge

Espe Sogn

Hillerslev Sogn

Grusgrav

Fredskov

Ealles Grusgrav

Nyeboelle

af Espe

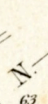



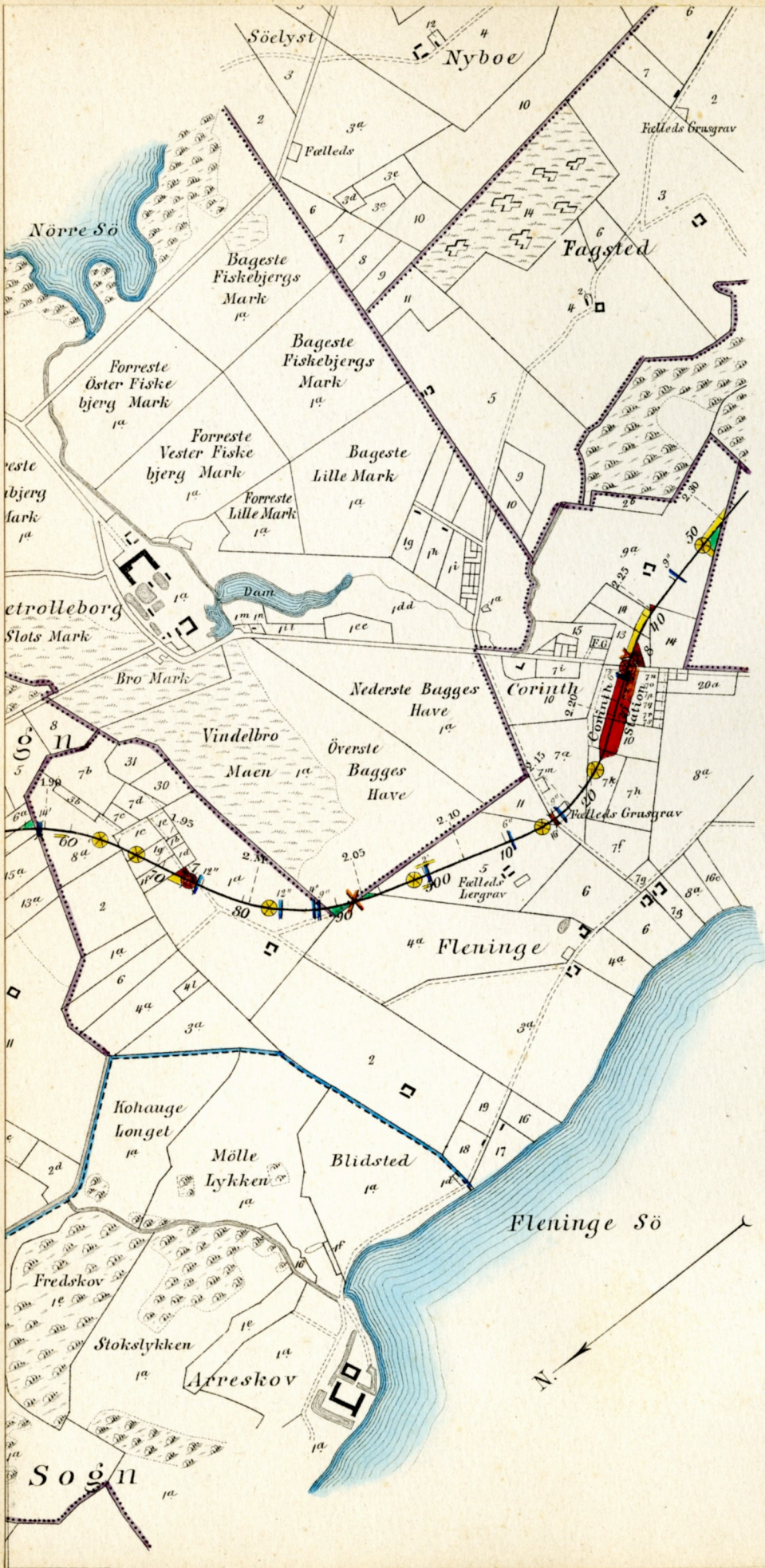

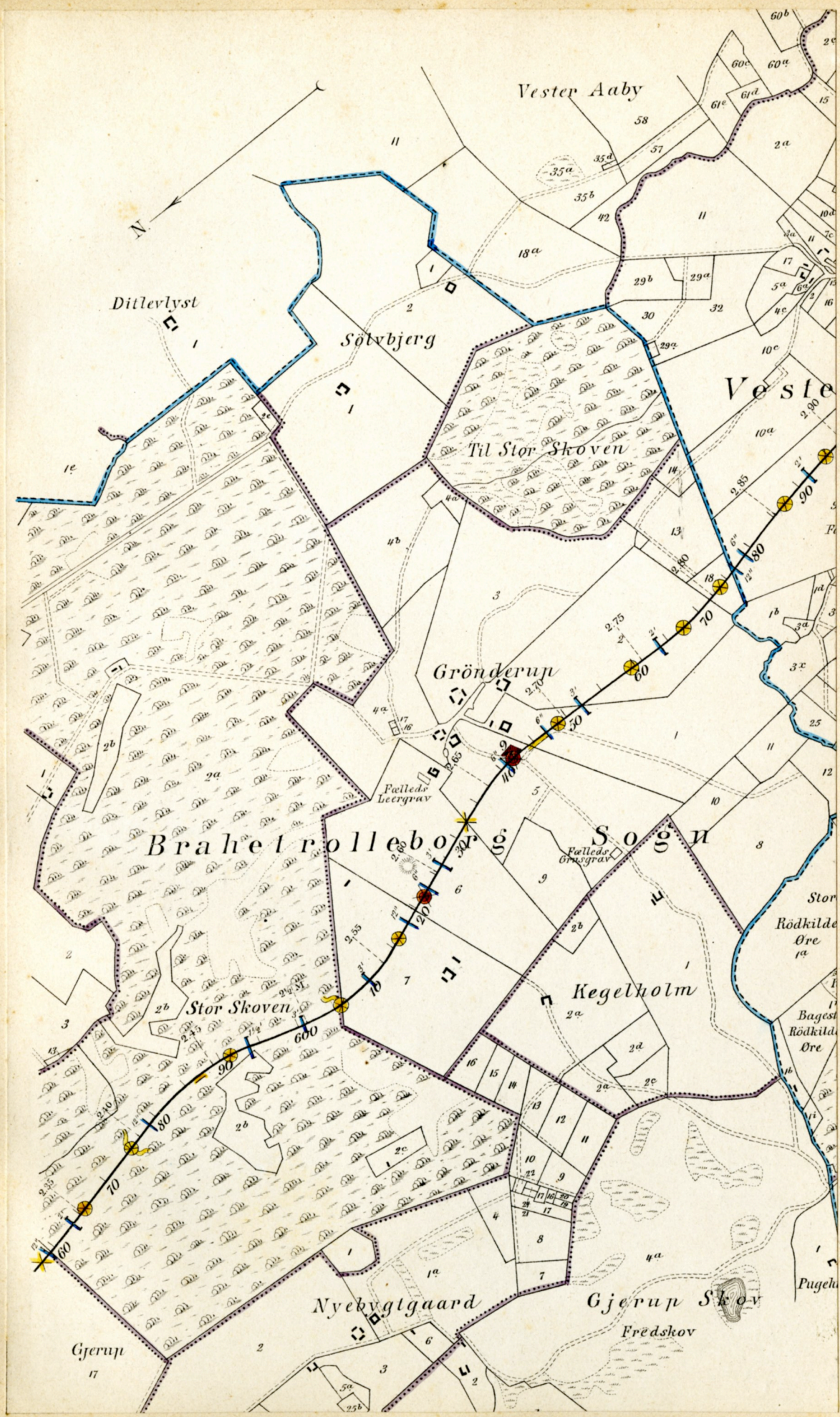

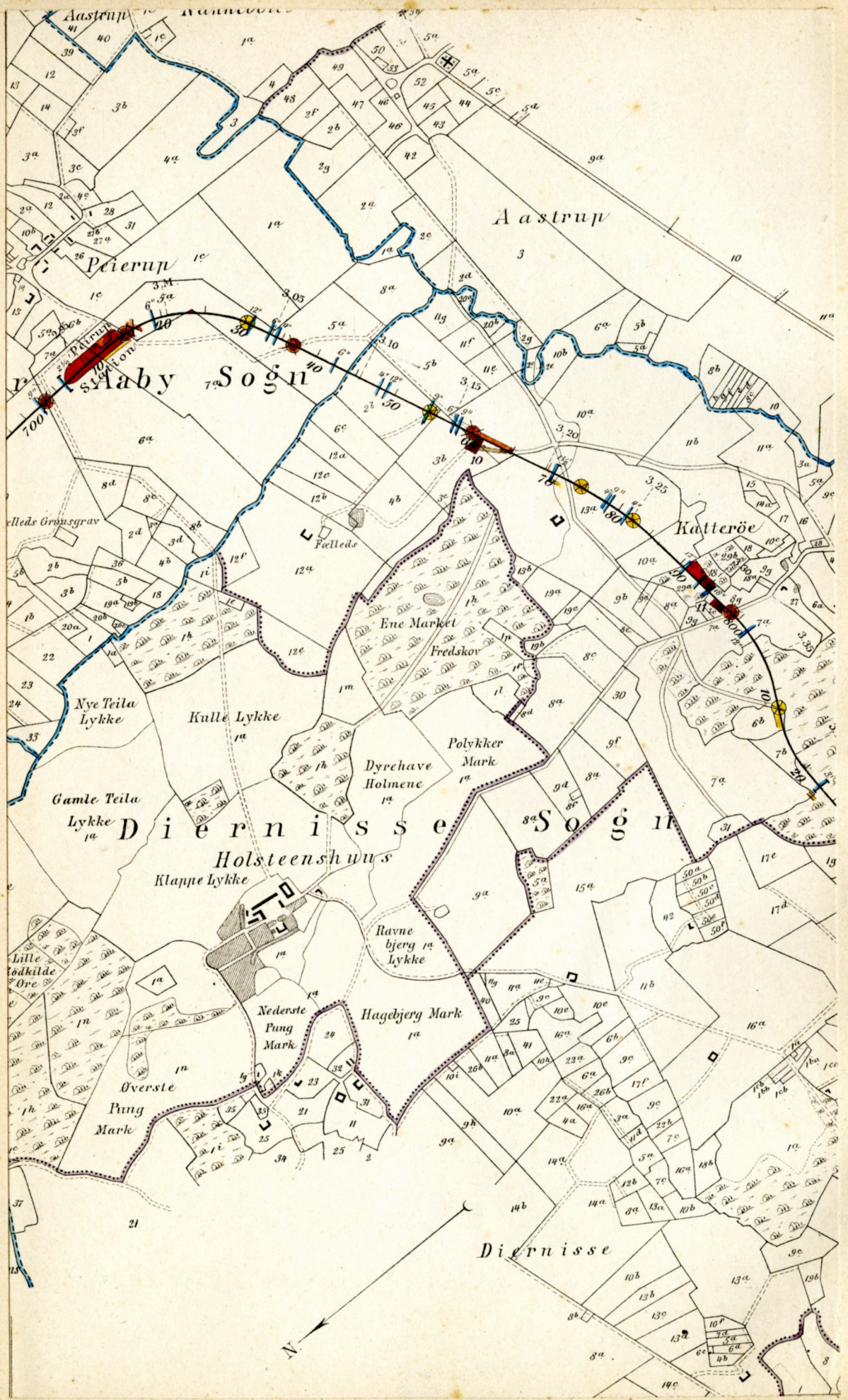

Aastrup

Peierup

Aastrup Sogn

Katterøe

Ene Mark

Frelskov

Polykker Mark

Dyrhave Holmene

Ravnebjerg Lykke

Hagebjerg Mark

Gamle Teila Lykke

Kulle Lykke

Holsteenshus

Klappe Lykke

Overste Pung Mark

Pung Mark

Diernisse

Diernisse

Diernisse



700

